

# Soils Map

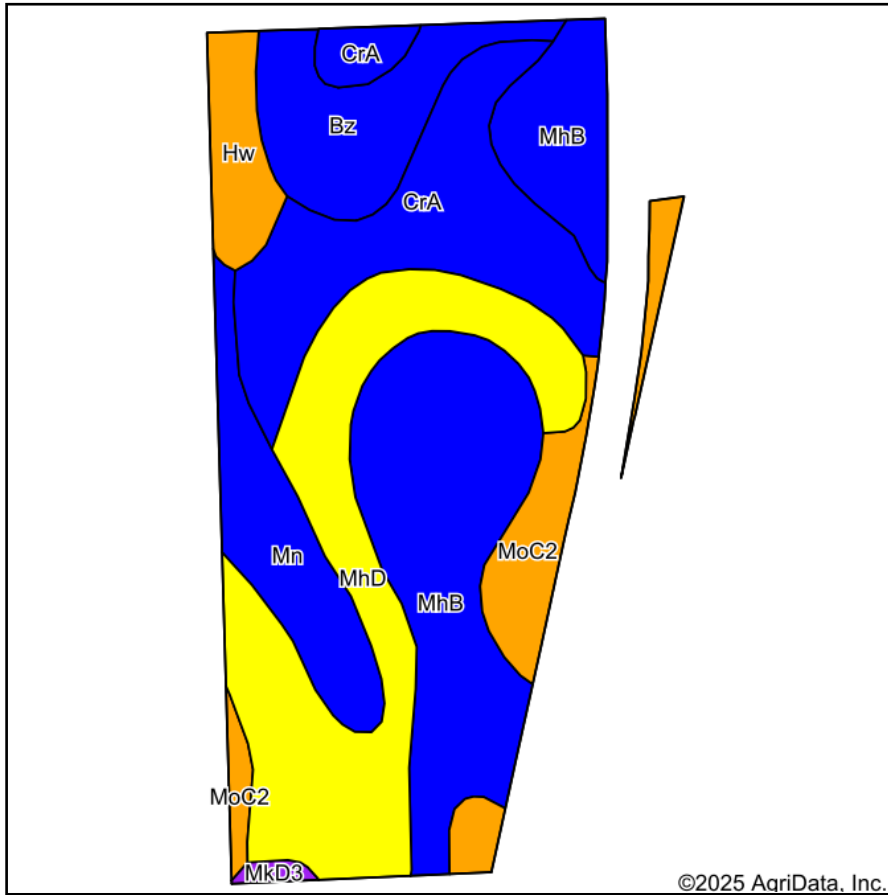

Soils data provided by USDA and NRCS.

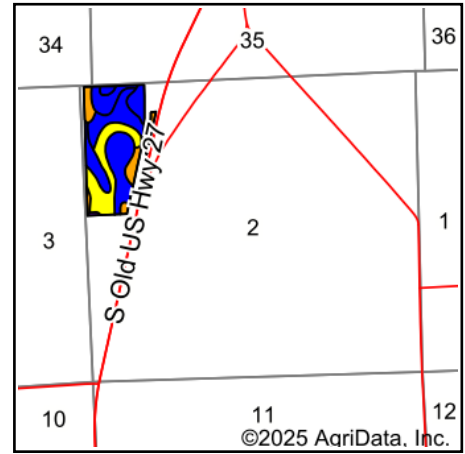

State: **Indiana**  
 County: **Steuben**  
 Location: **2-36N-13E**  
 Township: **Steuben**  
 Acres: **40.5**  
 Date: **7/30/2025**

**SCHRADER**  
 Real Estate and Auction Company, Inc.

Maps Provided By:  
**surety**  
 CUSTOMIZED ONLINE MAPPING  
 © AgriData, Inc. 2023 www.AgriDataInc.com



Area Symbol: IN151, Soil Area Version: 27

Code	Soil Description	Acres	Percent of field	Non-Irr Class Legend	Non-Irr Class	Corn Bu	Corn silage Tons	Grass legume hay Tons	Grass legume pasture AUM	Pasture AUM	Soybeans Bu	Winter wheat Bu
MhB	Miami loam, 2 to 6 percent slopes	11.01	27.1%		Ile	144	17	5		10	48	63
MhD	Miami loam, 12 to 18 percent slopes	9.72	24.0%		IVe	124	18	4	8		43	56
CrA	Crosier loam, 0 to 3 percent slopes	7.37	18.2%		IIw	140	19	5		9	46	63
Bz	Brookston loam	3.71	9.2%		IIw	175	24	6		12	49	70
Mn	Milford silty clay loam, 0 to 2 percent slopes	3.56	8.8%		IIw	154		5		11	43	62
MoC2	Morley silt loam, 6 to 12 percent slopes, eroded	3.23	8.0%		IIIe	118	16	4	8		41	53
Hw	Houghton muck, drained	1.70	4.2%		IIw	159		5		11	42	64
MKD3	Miami clay loam, Saginaw lobe, 12 to 18 percent slopes, severely eroded	0.20	0.5%		VIe	110	16	4	7		39	51
Weighted Average					2.62	140.6	16	4.8	2.6	6.9	45.2	61.1

Soils data provided by USDA and NRCS.