

# Soils Map

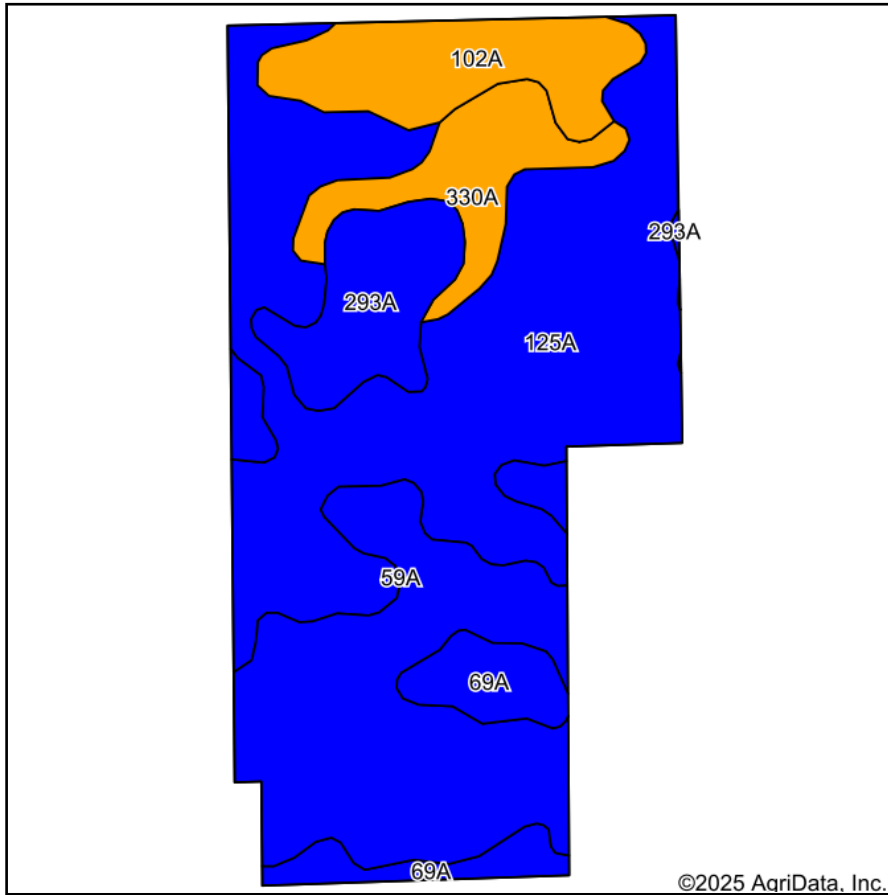

Soils data provided by USDA and NRCS.

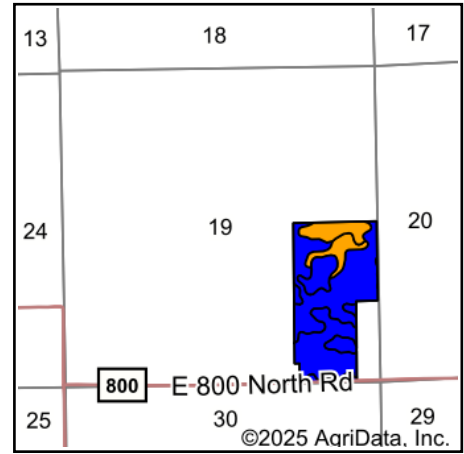

State: **Illinois**  
 County: **Iroquois**  
 Location: **19-25N-11W**  
 Township: **Stockland**  
 Acres: **74.15**  
 Date: **4/3/2025**

**SCHRADER**  
 Real Estate and Auction Company, Inc.

Maps Provided By:  
**surety**  
 CUSTOMIZED ONLINE MAPPING  
 © AgriData, Inc. 2023 www.AgriDataInc.com



Area Symbol: IL075, Soil Area Version: 18												
Code	Soil Description	Acres	Percent of field	Il. State Productivity Index Legend	Subsoil rooting <sup>a</sup>	Corn Bu/A	Soybeans Bu/A	Wheat Bu/A	Oats Bu/A <sup>b</sup>	Sorghum <sup>c</sup> Bu/A	Grass-legume <sup>e</sup> hay, T/A	Crop productivity index for optimum management
**125A	Selma loam, 0 to 2 percent slopes	32.43	43.8%		FAV	**176	**57	**70	**90	**1	**8.00	**129
59A	Lisbon silt loam, 0 to 2 percent slopes	19.53	26.3%		FAV	188	59	74	104	0	6.00	136
**102A	La Hogue loam, 0 to 2 percent slopes	6.95	9.4%		FAV	**162	**52	**71	**80	0	**5.00	**121
293A	Andres silt loam, 0 to 2 percent slopes	5.69	7.7%		FAV	184	59	71	97	0	5.00	135
**330A	Peotone silty clay loam, 0 to 2 percent slopes	5.22	7.0%		FAV	**164	**55	**61	**78	0	**5.00	**123
**69A	Milford silty clay loam, 0 to 2 percent slopes	4.33	5.8%		FAV	**171	**57	**68	**88	0	**6.00	**128
Weighted Average						177.3	57.1	70.5	92.3	0.4	6.6	130.1

**Table: Optimum Crop Productivity Ratings for Illinois Soil EFOTG are sourced from Bulletin 811 calculated Map Unit Base Yield Indices, and adjusted (Adj) for slope, erosion, flooding, and surface texture.** Publication Date: 01-28-2025

Crop yields and productivity (B811 EFOTG) are maintained at the following USDA web site: 2023 Illinois Soil Productivity and Yield Indices: <https://efotg.sc.egov.usda.gov/#/state/IL/documents/section=2&folder=52809>

\*\* Base indexes from Bulletin 811 adjusted for slope, erosion, flooding, and surface texture according to the Il. Soils EFOTG

<sup>b</sup> Soils in the southern region were not rated for oats and are shown with a zero "0".

<sup>c</sup> Soils in the northern region or in both regions were not rated for grain sorghum and are shown with a zero "0".

<sup>e</sup> Soils in the well drained group were not rated for grass-legume and are shown with a zero "0".

Soils data provided by USDA and NRCS. Soils data provided by University of Illinois at Champaign-Urbana.