

The following dimensions are approximate interior wall to wall dimensions, measured on site, from the widest portion of each room, then calculated to Feet/Inches from Rounded Decimal Feet. Information deemed reliable, but not guaranteed.

Sketch

Case Number: 20230501-1 File Number: 202305
 Address: 94 Sunny Ridge Lane
 City / State: Pittsboro / NC Zip / County: 27312 /
 Borrower:
 Lender or Client: Eric Andrews Address: Prepared By A...
 Prepared By: Laura Fuelleman

Electricity was not available upon at the time of measurement.
 Further inspection is required to determine functionality of heating and cooling systems.

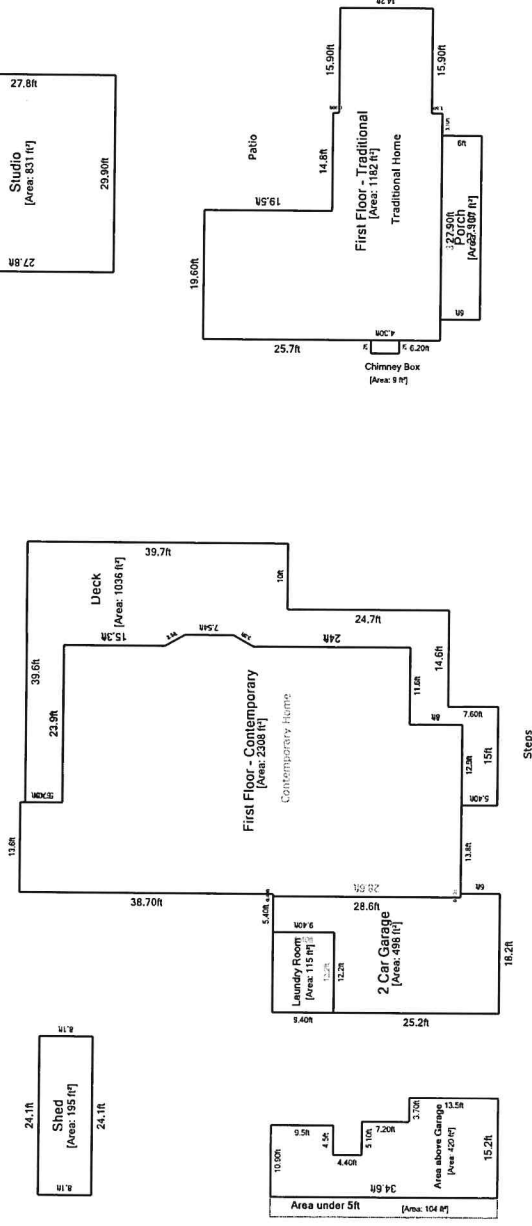

28 ft

Living Area	
Laundry Room	114.68 ft² 2 Car Garage
First Floor - Traditional	1182.46 ft² Deck
Studio	831.22 ft² Area above Garage
First Floor - Contemporary	2307.86 ft² Area under 5ft
	Porch
	Chimney Box
	Shed
Total Living Area (rounded):	4436 ft² Total Non-Living Area (rounded):
	2429 ft²

This document is designed to be a record of total finished square feet to aid the listing agent in gathering the square feet facts of the property. Measurements are obtained by physical observation of the property by a certified Home Measurement Specialist. The method of measuring the subject home is in accordance with the NC Residential Square Footage Guidelines and those approved by the American National Standards Institute, Inc (ANSI), which are recognized by the North Carolina Real Estate Commission as comparable standards. Within every measurement project, some degree of art of opinion may be applied as well as rounding as set forth in the standards. Final finished square footage will be rounded to the nearest whole number with the goal of being within a 5% margin of error. Information deemed reliable, but not guaranteed.

