

Larson & McGowin

PROPERTIES

Mortar Creek TRACT

267± Acres In Elmore County, Alabama

\$693,966

Approximately 267± acres in Autauga and Elmore Counties. The Mortar Creek Tract is accessed from Bond Road and has almost 80± acres of hardwood stands around the banks of Mortar Creek and its tributaries. The remainder of the tract is both fresh clearcut and Loblolly plantation planted in 2020. **Offered at \$693,966.**



**Chandler
Graham**
Qualifying Broker

cgraham@larsonmcgowin.com

Phone: 205.977.7706 | Mobile: 334.734.1382

www.larsonmcgowinproperties.com

500 Office Park Drive Suite 430 Birmingham, AL 35223 | Branch Offices: Greenville, Alabama | Mobile, Alabama | Merryville, Louisiana
Licensed in AL, MS, TN, LA, TX, AR, GA, KY, FL, & SC



USGS The National Map: Orthoimagery. Data refreshed December, 2021.

0 330 660 1,320
Feet

Mortar Creek Tract
267+- Acres **June 13, 2022**

Map is for illustrative purposes only. Accuracy is not guaranteed. **Autauga & Elmore County, AL**



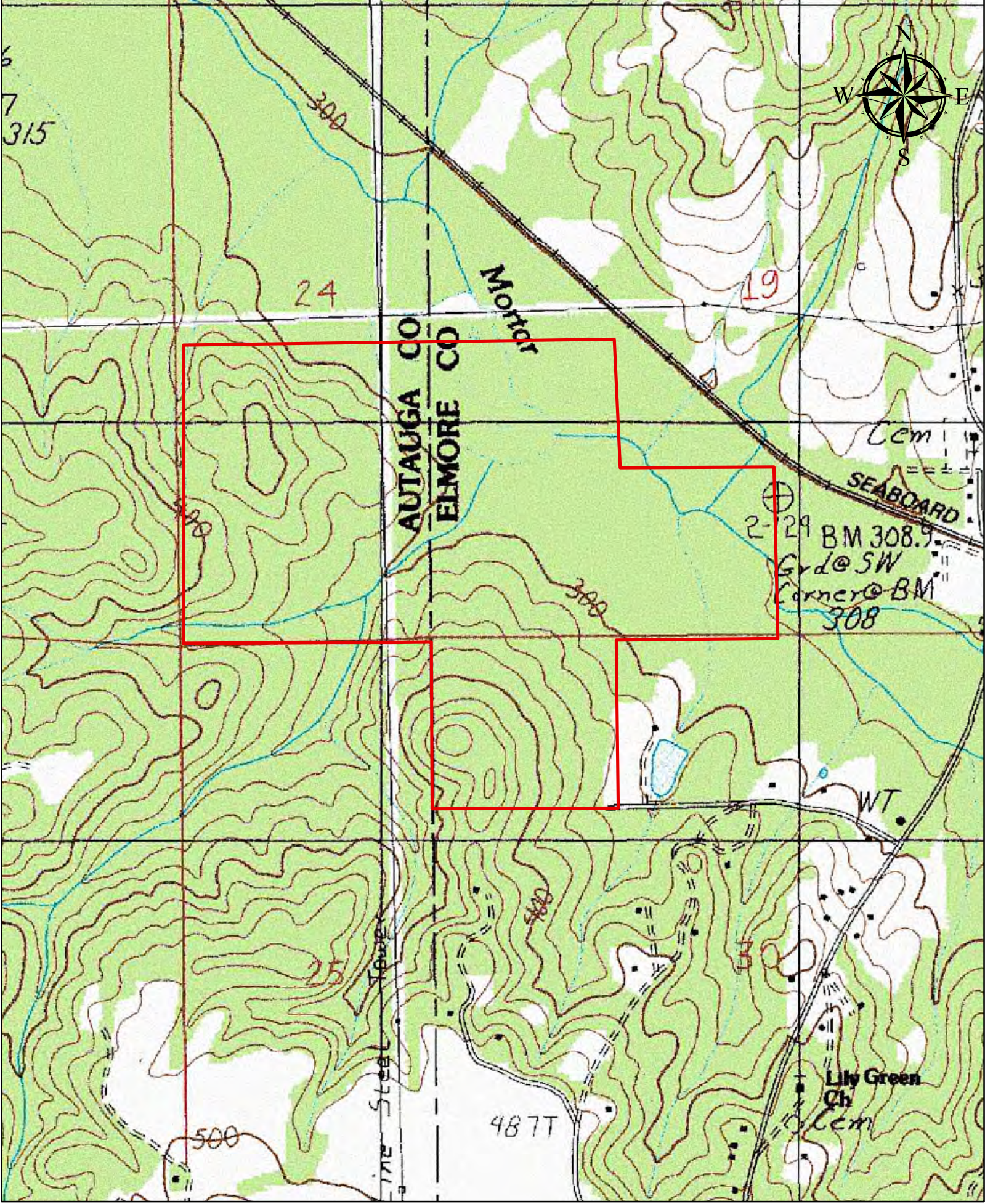

0 330 660 1,320 Feet

Mortar Creek Tract
267+- Acres
June 13, 2022

Map is for illustrative purposes only. Accuracy in not guaranteed Autauga & Elmore County, AL



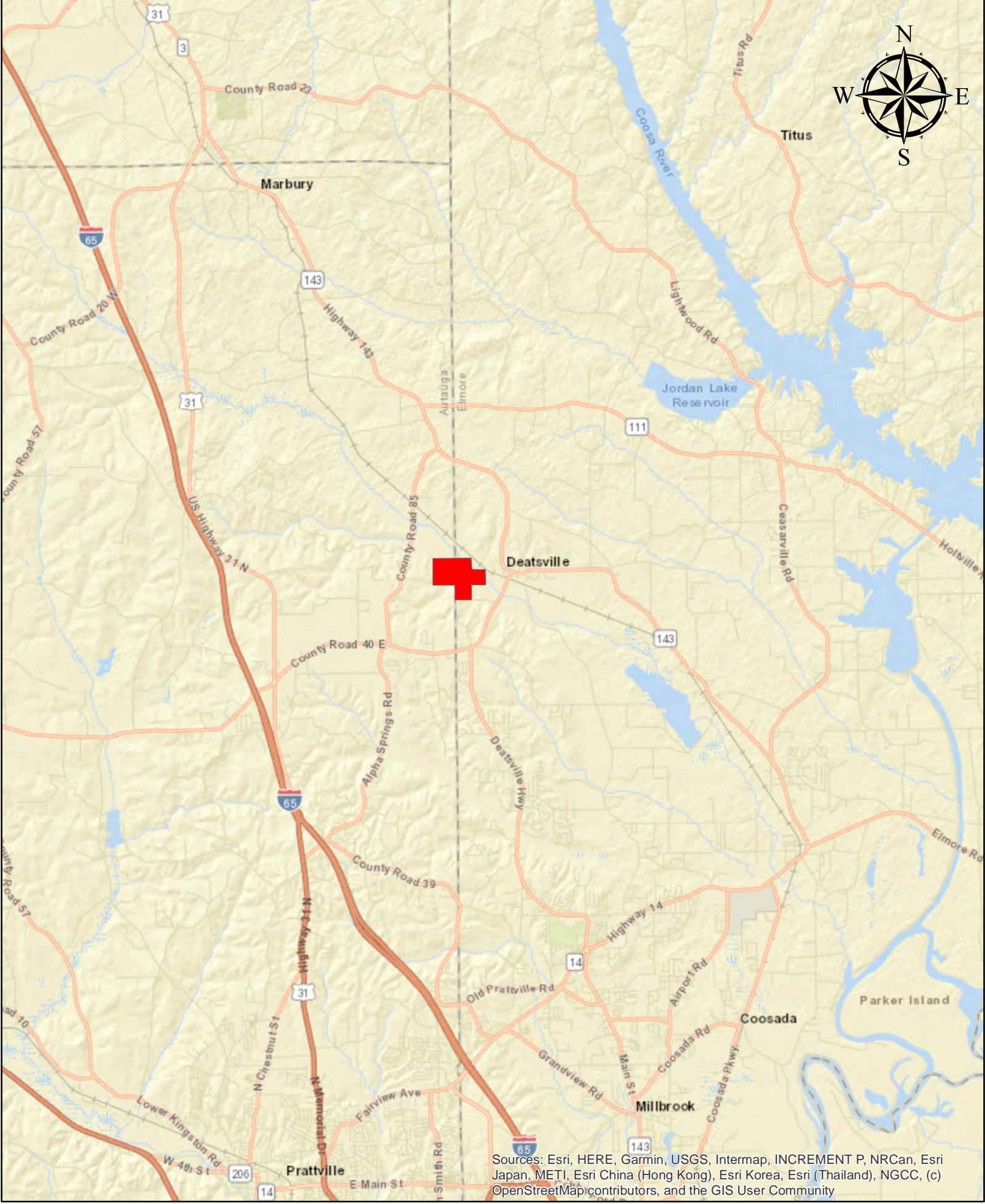

Sources: Esri, HERE, Garmin, USGS, Intermap, INCREMENT P, NRCan, Esri Japan, METI, Esri China (Hong Kong), Esri Korea, Esri (Thailand), NGCC, (c) OpenStreetMap contributors, and the GIS User Community

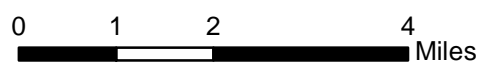

Mortar Creek Tract
267+- Acres **June 13, 2022**

Map is for illustrative purposes only. Accuracy in not guaranteed Autauga & Elmore County, AL

