



Alamance County Government

TAX ADMINISTRATION RECORD SEARCH

Property Owner FOWLER STEVEN ANTHONY & DIANE MARIE FOWLER	Owner's Mailing Address	Property Location Address QUAKENBUSH RD
---	--------------------------------	---

Administrative Data Parcel ID No. 173799 OLD Tax ID 8-24-176 GPIN 8777861480 Owner ID 0682768 Tax District 44 - SNOW CAMP Land Use Code 010 Land Use Desc SINGLE FAMILY Neighborhood R4413	Administrative Data Legal Desc QUAKENBUSH RD TRACT 1 Deed Year Bk/Pg 2018 - 3839 / 0132 Plat Bk/Pg 078 / 0203 Sales Information Deed Name Sold Date 0--0 Sold Amount \$ 0	Valuation Information Tax Value \$ 73,212 Tax Value - Land and all permanent improvements, if any, effective January 1, 2017, date of County's most recent General Reappraisal Assessed Value \$ 73,212 If Assessed Value does not equal Market Value, then the parcel may be in a tax deferment program, be split by the county line, or be overridden to match an alternative valuation approach.
---	---	--

Improvement Detail (1st Major Improvement on Subject Parcel)	
Year Built	1994
Built Use/Style	OTHER
Current Use	E / POOR QUALITY (E)
Grade	E / POOR QUALITY (E)
* Percent Complete	100
Heated Area (S/F)	204
Fireplace (Y/N)	N
Basement (Y/N)	N
** Bedroom(s)	0
** Bathroom(s)	0 Full Bath(s) 0 Half Bath(s)
*** Multiple Improvements	001
<small>* Note - As of January 1 ** Note - Bathroom(s), Bedroom(s), shown for description only *** Note - If multiple improvements equal "MLT" then parcel includes additional major improvements</small>	

Sales History 2 Previous Sales Found for Parcel number 173799				
Record Num	Sales Year	Name	Book/Page	Sale Price
1	2019	FOWLER STEVEN ANTHONY & DIANE MARIE FOWLER	3839 / 0132	\$97,000.00
2	2019	COVINGTON-HICKS PATRICIA LYNN	3751 / 0835	\$0.00

Building Sketch

(Building 1) - Sketch for Parcel ID: 173799

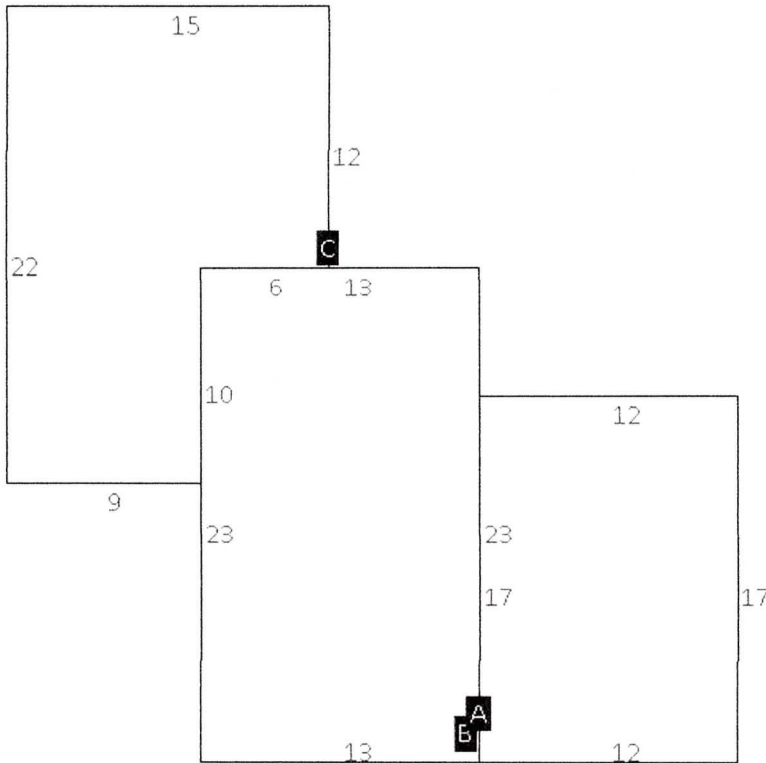

Label	Description	Base SF	Total SF
A	SITE BUILT	204.00	204.00
B	OPEN PORCH	299.00	.00
C	WOOD DECK	270.00	.00

Land Supplemental

Deeded Acres **15.584**
 Tax District Note **44 - SNOW CAMP**
 Present-Use Info **SINGLE FAMILY**

Improvement Valuation (1st Major Improvement on Subject Parcel)

* Improvement Tax Value \$

** Improvement Assessed Value \$

9,371

* Note - Tax Value effective Date equal January 1, 2017, date of County's most recent General Reappraisal

** Note - If Assessed Value not equal Tax Value then variance resulting from formal appeal procedure

Land Value Detail (Effective Date January 1, 2017, date of County's most recent General Reappraisal)

Land Full Value (LFV) \$	Land Present-Use Value (PUV) \$ **	Land Total Assessed Value \$
63,841	63,841	63,841

** Note: If PUV equal LMV then parcel *has not* qualified for present use program