

Soils Map

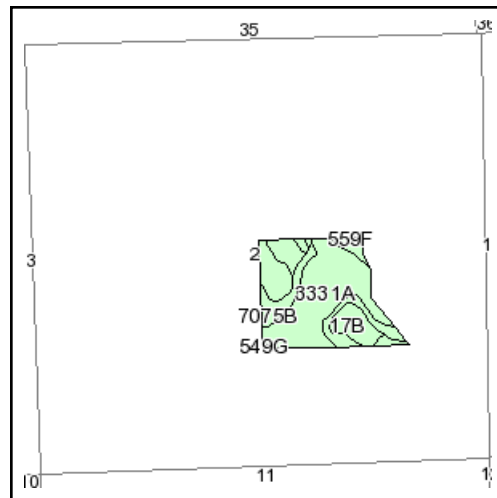

State: **Illinois**
 County: **Adams**
 Location: **002-003S-005W**
 Township: **Beverly**
 Acres: **41.2**

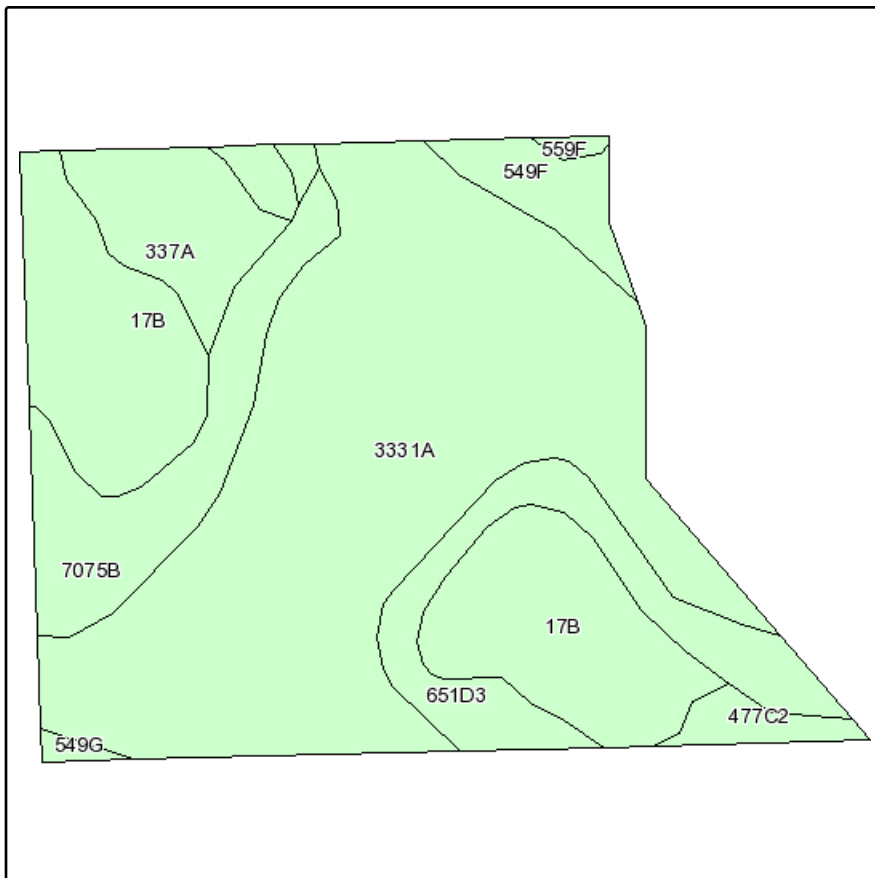
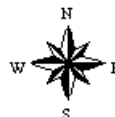

Maps provided by:



Fsa borders provided by the Farm Service Agency as of May 23, 2008.
 Soils data provided by USDA and NRCS.
 PLSS provided by Illinois State Geological Survey.

Code	Soil Description	Acres	Percent of field	Non-Irr Class	Corn	Grass legume hay	Grass legume pasture	Oats	Soybeans	Winter wheat
3331A	Haymond silt loam, 0 to 2 percent slopes, frequently flooded	20.2	49.0%	IIw	147	4.7	6.9		46	
17B	Keomah silt loam, 2 to 5 percent slopes	8.8	21.5%	Ile	144	4.6	6.7	74	46	58
7075B	Drury silt loam, 2 to 5 percent slopes, rarely flooded	3.8	9.1%	Ile	154	5.2	7.7	76	48	60
651D3	Keswick clay loam, 10 to 18 percent slopes, severely eroded	3.6	8.7%	Vle		2.5	3.5			
337A	Creal silt loam, 0 to 2 percent slopes	2.4	5.9%	IIw	136	3.6	5.3		43	53
549F	Marseilles silt loam, 18 to 35 percent slopes	1.4	3.5%	VIIe			2.7			
477C2	Winfield silt loam, 5 to 10 percent slopes, eroded	0.7	1.7%	IIIe	136	4.2	6.1		42	53
549G	Marseilles silt loam, 35 to 60 percent slopes	0.2	0.4%	VIIe			2.2			
559F	Lindley loam, 18 to 35 percent slopes	0.1	0.3%	Vle		2.7	3.9			
Weighted Average					127.3	4.3	6.4	22.8	40	22