

Raccoon Creek
Gallia County - Clay Township



Trails at Creek



Lot 1 Creek Bend



Drop in your line or your feet, the waters great. Got a boat? Take it down to the Ohio River or head for the Mississippi! Not a boater? Enjoy the beautiful meadows or the majestic woods. Just three miles down Raccoon Creek is the Ohio River. This creek is deep and wide allowing large boats to traverse its waters much further up stream past our property. Houseboats and all types of boats navigate this creek! This property offers Woods, Meadows, and Water, making it the perfect Getaway or a great Home Site. If you've wanted a family vacation retreat, hunting camp, or home on a creek in the country, this is the one! Private and Secluded!

Directions from SR 7 and SR 218:
Take SR 218 for 3 miles to go left on Clay Chapel Road at the Elizabeth Chapel Church. Property is about 1 mile down Clay Chapel Road on the left at gravel "Creek Side Drive" entrance into the property.

About 1/2 mile down Clay Chapel, you'll come to a "Y" at sign for Davidsons Greenhouse. Continue left on Clay Chapel past greenhouse to the property. Address of Elizabeth Chapel Church is 4905 Clay Chapel Road, Gallipolis, Address near area Raccoon Creek crosses SR 7 is 11005 SR 7, Gallipolis 45631.

From SR 7 & Bear Run Road: Go East on Bear Run for 1.4 miles to go right on Clay Chapel. Follow for 1.1 miles to Creek Side Drive on the right. Raccoon Creek goes under SR 7 near Bear Run Road.



Pond on Lots 4-5
At #3 looking toward #4-12

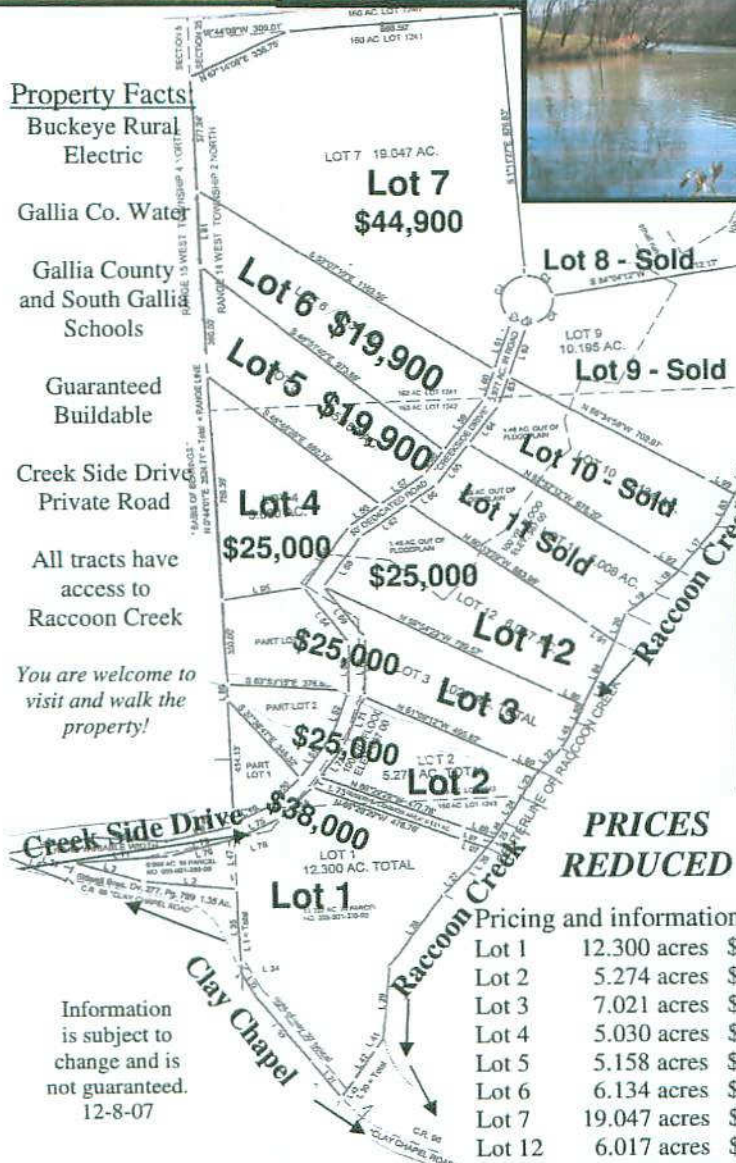

Property Facts

- Buckeye Rural Electric
- Gallia Co. Water
- Gallia County and South Gallia Schools
- Guaranteed Buildable
- Creek Side Drive Private Road
- All tracts have access to Raccoon Creek
- You are welcome to visit and walk the property!

PRICES REDUCED

Pricing and information...

Lot 1	12.300 acres	\$ 38,000
Lot 2	5.274 acres	\$ 25,000
Lot 3	7.021 acres	\$ 25,000
Lot 4	5.030 acres	\$ 25,000
Lot 5	5.158 acres	\$ 19,900
Lot 6	6.134 acres	\$ 19,900
Lot 7	19.047 acres	\$ 44,900
Lot 12	6.017 acres	\$ 25,000

Information is subject to change and is not guaranteed. 12-8-07



Lot 4 9-16-06 looking toward lots 3-1

For Info Contact: **Deborah Cribben 800-213-8365**
cell: **740-710-0441** e-mail: **DeborahC@Countrytyme.com**
Countrytyme, 1660 Gateway Circle, Grove City, OH 43123